

# smart canvas

## INSTRUCTION

Feeling time, enjoying time

BSJ100-03

### For safe use

To use this product safely, be sure to read the product instructions before use.

If the product is not handled according to the instructions, it may lead to a failure or accident.

Keep the instructions of this product at hand so that any unclear points about the product can be solved any time.

### Meanings of symbols

In the instructions of this product, warnings for dangerous operation and handling are indicated with the following symbols to prevent harm to you and other people and damage to property in advance. Read the text of the instructions after understanding their meanings.

	Indicates operation or handling that may cause death or serious injury if conducted wrongly without paying attention to this symbol.
	Indicates operation or handling that may cause injury or damage to property if conducted wrongly without paying attention to this symbol.
	This symbol indicates what you should do without fail (instruction, action).
	This symbol indicates an action (prohibited action) that you should not do.

### Cautions for handling of product

#### Cautions for use

**Warning**

- Do not use this product for scuba diving.
- This product is made of a precision machine and electronic components. Do not use or store it in the following places.
  - Places with a high temperature or variable temperature or humidity or places with volatile substances
  - Places with much oily smoke or dust
  - Places with fire
  - Places near strong magnetism (near a speaker, for example) or with static electricity
  - Places with strong vibrations

- Do not disassemble or repair this product by yourself.
  - Do not take out the battery from the body.

- Do not leave this product in places accessible to small children.
  - If an infant swallows a part of this product, it may be harmful for the body. Consult a doctor immediately.

- Stop using this product when the body becomes edged by corrosion, etc.
  - Consult our support center immediately.

**Caution**

- If you observe any allergic symptoms or skin irritation, stop wearing this product immediately and consult a specialist such as a dermatologist.

- The body has water resistance for everyday life. This product can withstand accidental contact with water during normal use. Do not operate the buttons in water or with water drops on them. The water resistant performance may be degraded.

- Do not pour strong running water directly from a faucet. The water pressure of tap water from a faucet is high enough to degrade the water resistant performance.

- Do not wear this product while taking a bath or a sauna. Steam, soap, or some component of a hot spring may accelerate the deterioration of the water resistant performance of the body or band or may cause rusting or change of color.

- Do not leave this product in places where chemical substances are released or places exposed to chemicals. If gasoline, nail polish, spray of cosmetics, cleaner, toilet detergent, and adhesive agent adhere to the body and the band, it may cause damage to them or a change of color.

### How to operate buttons

#### Button names and basic operation

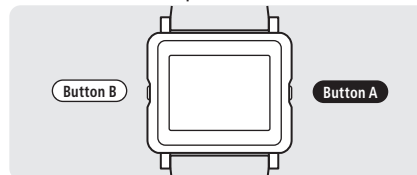

By pressing the button A or B, the display can be switched to a variety of backgrounds.

For details, refer to the product manual on the website.

\*The display may vary depending on the model (design).

### Check of model and product manual

#### 1. Check the download No. of the product manual.

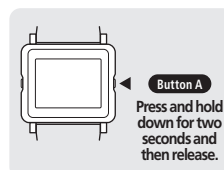

Display screen	Function included in each model Time and calendar; Birthday; Demo setting	Operation explanation for each model
	TIME WITH SECOND	With [BIRTHDAY/DEMO]
	Download No. of the product manual "AB123A (alphabetical character at the end)" *1	
	Download No. of the product manual "AB123 (numerical character at the end)" *2	Without [BIRTHDAY/DEMO]

\*1 and 2 The product manual download No. varies depending on the model.

\*3 "BIRTHDAY" is subject to change to other specifications without notice.

#### (1) Check the number in [ ] on the display screen.

\*The number in [ ] is the download No. of the product manual.

#### (2) When you press the button A or B, the display returns to the original display.

\*The display returns to the original display one minute later without operation.

#### 2. How to download product manual from website

(1) Access the website of Smart Canvas (<http://smartcanvas.jp>).

(2) Select "For users" => "Manual download" on the website.

(3) Select the product manual with the same number as the download No.

(4) You can check the product manual.

#### 3. Check the model.

If "TIME WITH SECOND" and "AB123A (alphabetical character at the end)" are displayed, refer to "Model with [BIRTHDAY/DEMO]."

If "秒表示" and "AB123 (numerical character at the end)" are displayed, refer to "Model without [BIRTHDAY/DEMO]."

### Model with [BIRTHDAY/DEMO]

#### How to set the time and calendar

##### 1. Time setting

**1) TIME & CALENDAR is selected.**

**2) Select the 24H indication (AM or PM) by the [Button B].**

**3) Set the hours by the [Button B].**  
\*Press and hold down the button B to advance the hour by 6 hours.

**4) Set the minutes by the [Button B].**  
\*Press and hold down the button B to advance the minute by 10 minutes.

**5) Press the [Button A] simultaneously with the time signal.**  
\*When the button B is pressed to change the minute, the second will be set to "00".

**6) The display returns to time display.**  
\*To move on to calendar setting, follow the procedures in "2. Calendar setting (year, month, date)."

##### 2. Calendar setting (year, month, date)

**1) TIME & CALENDAR is selected.**

**2) The display enters the 24H indication (AM, PM) setting mode.**

**3) The display enters the hour setting mode.**

**4) The display enters the minute setting mode.**

**5) Set the year by the [Button B].**  
\*Press and hold down the button B to advance the year by 10 years. When the year reaches 2062, it returns to the default value.

**6) Set the month by the [Button B].**  
\*Press and hold down the button B to advance the month by 6 months.

**7) Set the date by the [Button B].**  
\*Press and hold down the button B to advance the date by 10 days.

**8) The display returns to time display.**  
\*After pressing the button A, the display does not return to the previous setting mode.

#### How to set the birthday

\*This is a function only for the models with [BIRTHDAY/DEMO].

\*The birthday can be set and a special screen is displayed on that day.

##### 1. Set the birthday.

**1) TIME & CALENDAR is selected.**

**2) BIRTHDAY is selected.**  
\*When the birthday is not set, "--:--" is displayed. The birthday is displayed when it is set.

**3) Set the birth month by the [Button B].**  
\*When it is not set, the current date is displayed.  
\*Press and hold down the button B to advance the month by 6 months.  
\*To cancel the setting, press the button B repeatedly until "--:--" is displayed.

**4) Set the birth date by the [Button B].**  
\*Press and hold down the button B to advance the date by ten days.

**5) The display returns to time display.**

#### DEMO (Demonstration)

\*This is a function only for the models with [BIRTHDAY/DEMO].

\*DEMO is a function to continuously see images loaded in the model.

##### 1. See the demo.

**1) The demo start screen appears.**

**2) The demo is started.**  
\*The date and time displayed are previously set and different from the current ones.

**3) The screen returns to the demo start screen.**  
\*The demo is automatically finished when the display comes to an end.

**4) The display returns to time display.**

## How to set the time and calendar

### 1. Time setting

Press both buttons simultaneously (for 1 second).

**Button A** Press

(1) Select the 24H indication (AM or PM) by the button B.

**Button A** Press

(2) Set the hours by the button B. \*Press and hold down the button B to advance the hour by 6 hours.

**Button A** Press

(3) Set the minutes by the button B. \*Press and hold down the button B to advance the minute by 10 minutes.

"When the button B is pressed to change the minute, the second will be set to "00".

**Button A** Press

(4) Press the button A simultaneously with the time signal.

"The second will be displayed."

**Button A** or **Button B** Press

(5) The display returns to time display. \*To move on to calendar setting, follow the procedures in "2. Calendar setting (year, month, date)."

### 2. Calendar setting (year, month, date)

Press both buttons simultaneously (for 1 second).

**Button A** Press

(1) The display enters the 24H indication (AM, PM) setting mode. \*Press and hold down the button B to advance the hour by 6 hours.

**Button A** Press

(2) The display enters the hour setting mode. \*Press and hold down the button B to advance the hour by 6 hours.

**Button A** Press

(3) The display enters the minute setting mode. \*Press and hold down the button B to advance the minute by 10 minutes.

**Button A** Press

(4) Set the year by the button B. \*Press and hold down the button B to advance the year by 10 years. When the year reaches 2062, it returns to the default value.

**Button A** Press

(5) Set the month by the button B. \*Press and hold down the button B to advance the month by 6 months.

**Button A** Press

(6) Set the date by the button B. \*Press and hold down the button B to advance the date by 10 days.

**Button A** Press

(7) The display returns to time display. \*After pressing the button A, the display does not return to the previous setting mode.

## Access to dedicated website

**•MyEPSON**  
This is a membership information providing service for those who are interested in EPSON, regardless whether they use EPSON products or not. We deliver the latest recommended information that is exactly for you and help you to use the printer in a more enjoyable manner. User registration after purchase of the product is also easy. Now, make access immediately for membership registration.

Reply to simple questions to register

Access on the Internet!	<a href="http://myepson.jp/">http://myepson.jp/</a>
-------------------------	---

## Guarantee

- Guarantee for purchase on website**  
The purchase date in the guarantee is the shipping date on the invoice enclosed at the time of shipping of the product. Be sure to attach the invoice to the certificate of guarantee and keep it with care.
- Items to be guaranteed**  
- Product body (glass, case, interior parts)  
\*The band is out of the scope of guarantee.
- Guarantee period**  
One year from the purchase date.

## Specifications

- 1. Frequency of crystal oscillator** 32,768 Hz (Hz = Cycles per second)
- 2. Accuracy** Monthly rate within 20 seconds  
(If the watch is worn on the wrist within a temperature range between 5°C and 35°C.)
- 3. Operational temperature range** Between -5°C and + 50°C  
(Between 0°C and + 50°C for display function)
- 4. Display medium** Active Matrix Electrochromic Display
- 5. Power source** Small lithium battery 1 piece
- 6. Battery life** Approximately three years  
(Actual battery life may vary depending on use conditions.)

## Maintenance

### Care after use

Do not leave moisture, sweat and dirt on this product for a long time. After use, wipe the body with a wet towel wrung tightly and let it dry naturally. Moisture, sweat, and dirt may cause product failure. Do not wash this product with organic solvents such as benzene, thinner, alcohol, and detergent. Otherwise, it may cause deterioration.

### Leather band

- A leather band is susceptible to early deterioration from moisture and sweat. Wipe off moisture and sweat as soon as possible by gently blotting with a soft dry hygroscopic cloth.
- \* If the band is left wet, discoloration or change of color may occur.
- \* Do not expose this product to direct sunlight for a long time.
- \* Refrain from wearing this product while bathing, swimming, and when working with water.
- A leather band may deteriorate gradually even if it is not used.
- It is recommended to replace the leather band early if it has deteriorated.

### Battery incorporated in product body

- You cannot replace the battery incorporated in the product body by yourself.
- To replace the battery, contact our support center to request it. We will replace the battery for a fee.
- The battery incorporated in the product you purchased is set for inspection before factory shipping. The product may run short of power before the specified battery life expires.

### After-sale service

- For repair and inspection of this product, consult our support center.
- Basically, parts for repair of this product are retained for six years after discontinuation of manufacturing.

## Electrophoresis display (EPD)

- Switching of display**  
- An electrophoresis display has the characteristic that the display switches more slowly than a liquid crystal panel. At a low temperature, the display switches even more slowly.  
- Conduct operation after the display switches completely.
- Highlighting operation of display**  
- It is not a failure if the display of time, etc., is highlighted once a minute at the time of mode switching, etc. (It is an operation to maintain the display quality.)

### Caution

- Display at a high temperature**  
- Be careful so that the product does not become too hot.  
- If the temperature of this product becomes 50°C or more, the display disappears. If you press either of the buttons, a message "Too Hot Use Under 50°C" appears.
- Display at a low temperature**  
- The lower the temperature is, the paler the display becomes. In this case, put the product in a warm place and wait until the display returns to time display.  
\*This electrophoresis display (EPD) may become difficult to read with decreased contrast if you use it for a long period of time. Contact our support center for replacement. We will replace the display for a fee.

## Troubleshooting

### In case of the following display status

When the display status becomes as follows, refer to corresponding guidance.

Display	Contents	Do as follows
	These are not failures. They are displays for maintenance.	Press the button B. The display returns to the original display.
		Leave as it is and wait for a while until the display returns to time display.
	The temperature of the body is low.	Put the body in a warm place and wait for a while until the display returns to time display.
	When you press the button, a message "Too Hot Use Under 50°C" is displayed. -> The temperature of the body is 50°C or more.	Put the body in a cool place and wait for a while until the display returns to time display.
	This is not a failure. It is a display to warn that the product is running short of battery power. *1	Consult our support center.

\*1 "Replace Battery" is displayed depending on the model.

### System reset

If this product operates incorrectly, press and hold down both buttons A and B for 20 seconds. The system is reset when the buttons are released and the display enters the time setting mode about three seconds later.

## Smart Canvas band

The Smart Canvas band is a band that you can enjoy changing easily whenever you want.

- How to remove the band**  
Hold down the side of the attaching part of the band with your finger and push up the band vertically to remove it.  
⊘ Note that the band cannot be removed if you hold down the folded part with your finger.
- How to attach the band**  
(1) Push up the folded part of the attaching part of the band lightly with your finger.  
(2) Hang the end on the spring rod and pull down the band vertically.  
(3) Check if the band is attached firmly by pulling it in the direction shown in the figure.  
⊘ (4) If you pull it at a slant, the folded part is opened and will not be closed. Be sure to pull it straight down.

